

Mind Twisters

Packet #10

NAME: _____



The Remarkable Rebus

A rebus is a picture or symbol representing a word or phrase. Study each rebus below and write down the word or phrase it symbolizes. The first one has been done for you.

1.

You deserve a break
today.

2.

3.

4.

5.

6.

7.

8.

9.



Teacher's Day

Teacher's Day is celebrated around the world on or near October 5 each year. Read the clues below pertaining to teachers and write your answers in the blanks. Then, unscramble the letters in the squares and use them to answer the bonus question below.

1. another name for the diagram a teacher uses to learn students' names at the beginning of the year: _____ _____
2. what teachers assign to keep you busy after school: _____
3. what teachers write on when they want to convey visual information:
_____ _____
4. what you may earn if you misbehave in class: _____ _____
5. what your teacher expects you do to in class each day: _____ _____
6. a traditional gift given to teachers: _____ _____
7. the document teachers use to evaluate your progress at the end of the year:
_____ _____
8. a teacher's reference materials: _____ _____
9. where teachers must go to get a teaching credential that allows them to teach:
_____ _____
10. what a teacher looks forward to as much as you do! _____
_____ _____

Bonus:

What is the name of a famous teacher from ancient history? _____



Silly Phrases

Each of the clues below contains a number and some letters that symbolize commonly recognized phrases. Figure out each phrase, paying particular attention to the number in each one. The first one has been done for you.

1. 4 P on a C _____ four paws on a cat _____

2. 12 N on a C

3. 26 L in the A

4. 9 P in the SS

5. a P is W 1000 W

6. 1 W on a U

7. 4 Q in a G

8. 7 W of the W

9. a S in T S 9

10. 5 T on a F

11. 7 D in S W

12. 7 D of the W



Marvelous Machines

Decide which machine would work best for you in each of the following situations. Write your answers in the spaces below:

1. You have a kitchen full of dishes after a huge party.

2. You have to add up a long column of numbers to figure out income from babysitting.

3. You need to type a book report for English class.

4. You want to find out how fast you can run a mile.

5. You want to preserve a memory of your 12th birthday party set to music.

6. You need to make sure you wake up at 6:15 in the morning.

7. You want to tell your friend some news, even though he/she isn't home.

8. You need to clean your muddy jeans before school tomorrow.

9. You want your electric guitar to sound even louder.

10. You want to listen to phone messages without picking up the telephone.



Hobby Plates

A car license plate can tell something about its owner. Decode these plates to reveal clues about the owner's favorite hobby. The first one has been done for you.

1.

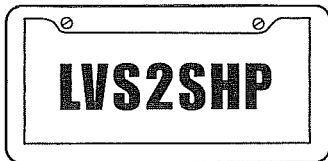

shopping

2.

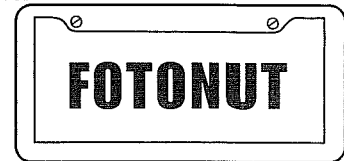

3.

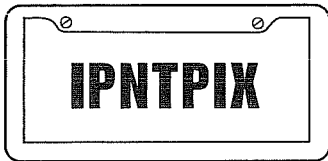

4.

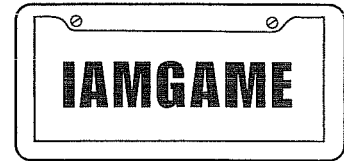

5.

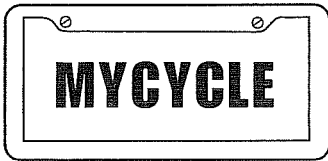

6.

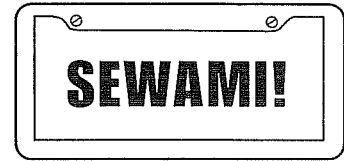

7.



8.



9.

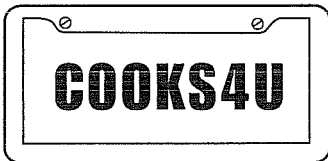

10.

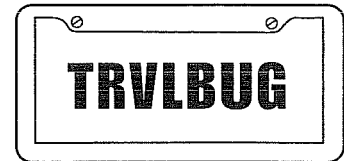

11.



12.

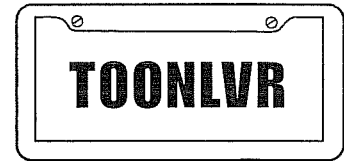



Fun with Geometry

Slice this shape into four identical parts.

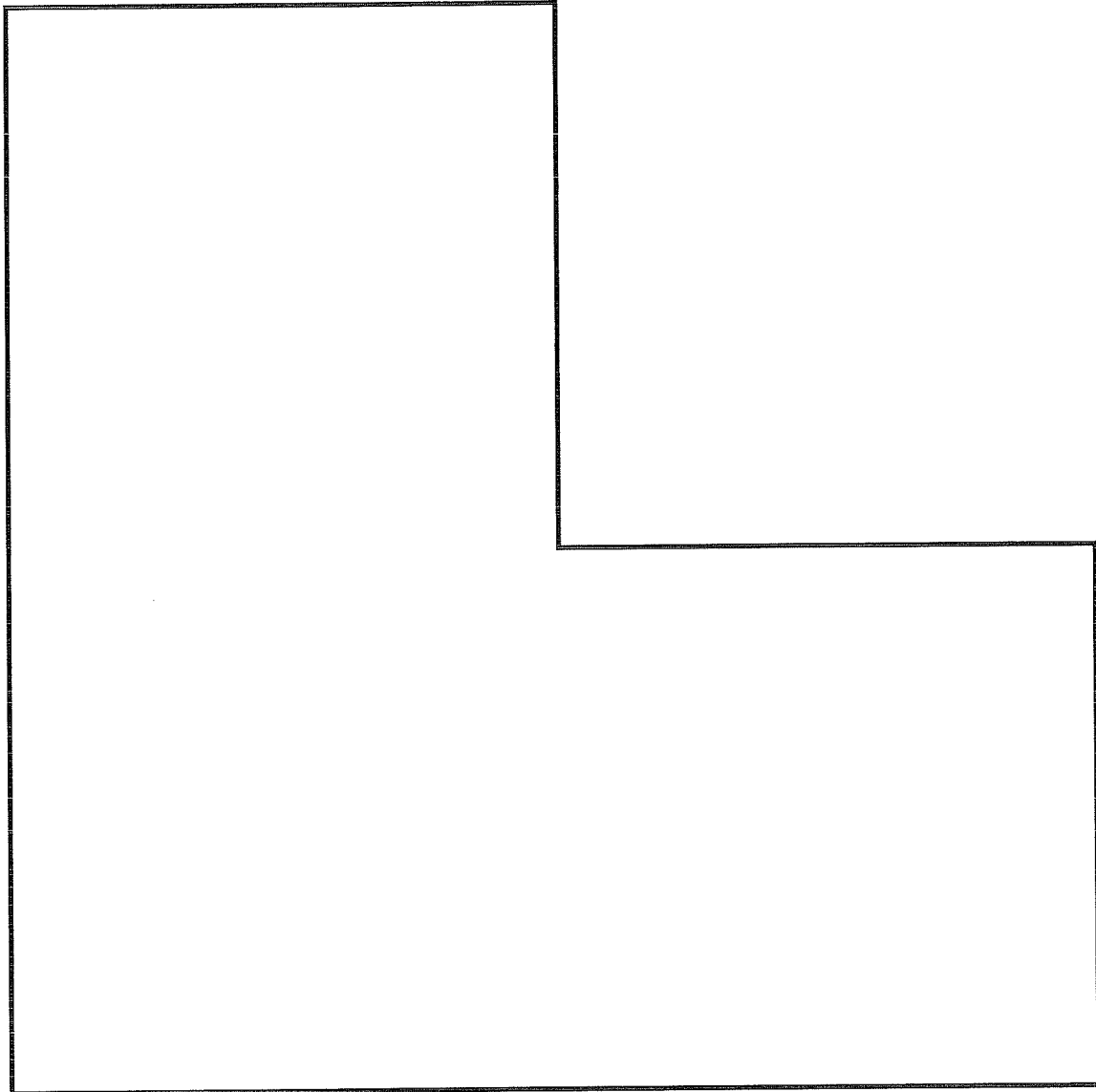



Chunked Greek Gods and Goddesses

The names of Greek gods and goddesses have been split into two- and three-letter chunks. The letters of the chunks are in order, but the chunks are scrambled. Put the letters together to identify these gods and goddesses. Use the clues to help you.

1. **NA AT HE**
I'm the goddess of wisdom, often shown with an owl. _____
2. **SE ON ID PO**
I'm the god of the sea. _____
3. **HR TE ODI AP**
I can make you fall in love with whomever I choose! _____
4. **LO AP OL**
I am the god of sunlight and music. _____
5. **MIS TE AR**
I'm the goddess of the moon, and I protect animals. _____
6. **AE HE US ST PH**
I'm the god of the blacksmith's fire. _____
7. **ES RM HE**
I am the messenger of the gods. _____
8. **ER DE MET**
I am the goddess of agriculture. _____
9. **IA HE ST**
I am the goddess of the hearth. _____
10. **US ON DI YS**
I am the god of wine. _____